

# Rocky Mountain **Go Play Turf** RM55

## Style Specification

The standard of quality of the synthetic grass product shall be **Go Play Turf** by Rocky Mountain Turf or an approved equivalent product meeting the following specifications



## Yarn Information

**Yarn #1 Type:** S-shape Monofilament  
**Color:** Olive Green / Apple Green  
**Total Denier:** 9900/9  
**Description:** Proprietary PE formulation for superior wear resistance  
**Yarn Cross Section:** S-shape

**Yarn #2 Type:** Texturized Thatch  
**Color:** Field Green / Jute  
**Total Denier:** 5500/8  
**Description:** Texturized monofilament PE thatch

**Total Yarn Face WT:** 55 Oz. / SqYd  
**Secondary Coating:** 20 Oz. Urethane / SqYd  
**Total Product WT:** 82 Oz. / SqYd

**Primary Backing:** Tencate K29, consisting of two warp knitted primaries  
**Primary Backing WT:** 7 Oz. / SqYd

## Tufting Information

**Pile Height:** Approx. 1"  
**Drainage Rate:** Standard, 3" x 4" pattern

**Roll Widths:** 15'  
**Tufting Gauge:** 3/8"

## Additional Information

This product is part of Rocky Mountain Turf's Product Series and was designed and engineered for Playground and Landscape artificial grass applications.

# Rocky Mountain *Impact Designs*

## Features

- Rocky Mountain Turf's rubber buffing is a durable unitary surface designed specifically for playgrounds. The surface serves as a rubber attenuation layer to minimize force of impact and is installed at different thicknesses to accommodate designated critical fall heights.
- The Rubber buffing surface is installed as a bottom layer under artificial turf in a playground surface system. This system provides an easily accessible and a durable surface allowing play for children and adults of all abilities.

## CAD Drawing

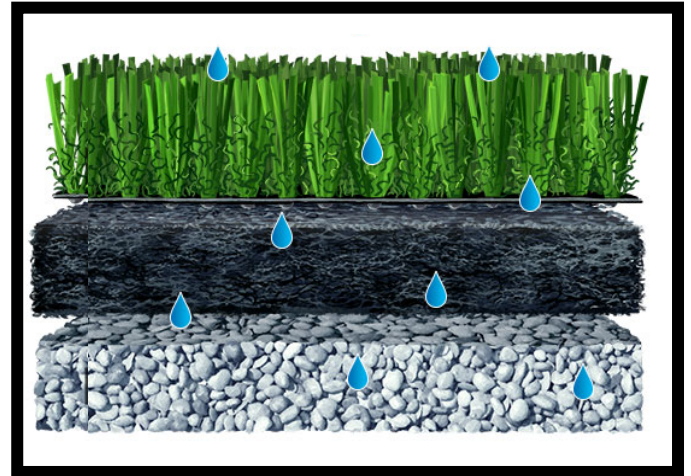

## Specifications

- Attenuating layer consists of recycled shredded rubber buffings with a urethane bonding agent and is installed per your equipment's requirements.
- Asphalt, concrete, or compacted stone base are suitable sub-bases

## Fall Height Chart

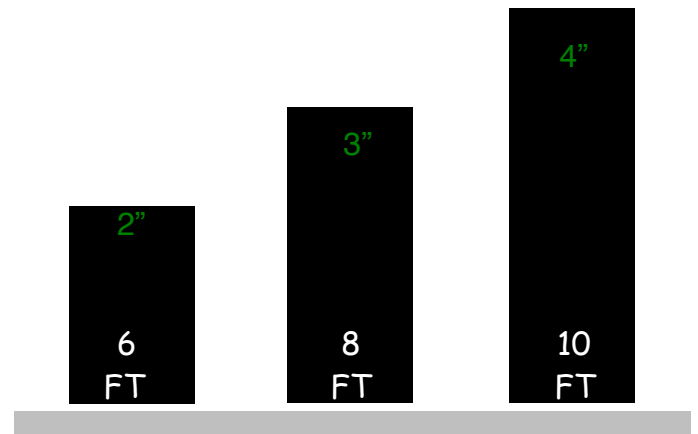

## Additional Information

This product is part of Rocky Mountain Turf's Product Series and was designed and engineered for playground artificial grass applications.



ROCKY MOUNTAIN TURF

# Potential Renderings for Playground Surfaces

## Artificial Turf with Foam Padding

## Artificial Turf with Rubber Base

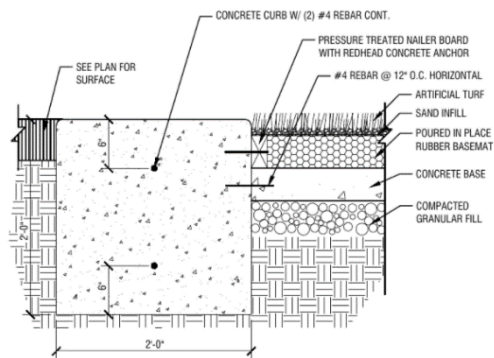

PLAYGROUND EDGE

1" = 1'-0"

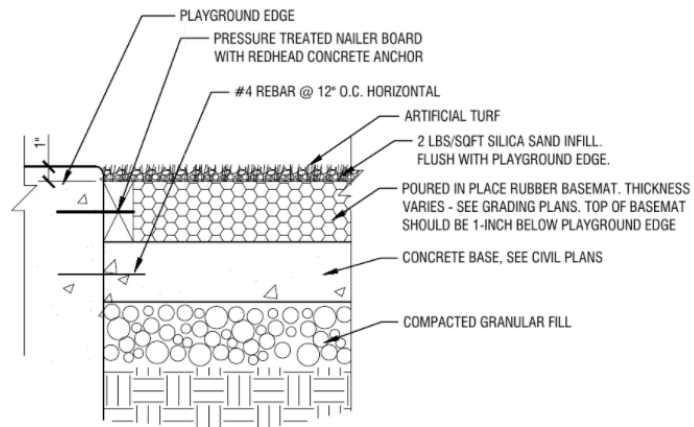

NOTE: TURF FASTENED TO NAILER BOARD W/ 1/4" X 1" GAL STAPLES

2

PLAYGROUND SURFACING

1 1/2" = 1'-0"

P-DS-65