



ROCKY MOUNTAIN TURF

Rocky Mountain *Go Play Turf* RM55

Style Specification

The standard of quality of the synthetic grass product shall be *Go Play Turf* by Rocky Mountain Turf or an approved equivalent product meeting the following specifications



Yarn Information

Yarn #1 Type: S-shape Monofilament
Color: Olive Green / Apple Green
Total Denier: 9900/9
Description: Proprietary PE formulation for superior wear resistance
Yarn Cross Section: S-shape

Yarn #2 Type: Texturized Thatch
Color: Field Green / Jute
Total Denier: 5500/8
Description: Texturized monofilament PE thatch

Total Yarn Face WT: 55 Oz. / SqYd
Secondary Coating: 20 Oz. Urethane / SqYd
Total Product WT: 82 Oz. / SqYd

Primary Backing: Tencate K29, consisting of two warp knitted primaries
Primary Backing WT: 7 Oz. / SqYd

Tufting Information

Pile Height: Approx. 1"
Drainage Rate: Standard, 3" x 4" pattern

Roll Widths: 15'
Tufting Gauge: 3/8"

Additional Information

This product is part of Rocky Mountain Turf's Product Series and was designed and engineered for Playground and Landscape artificial grass applications.



Rocky Mountain Impact Designs

Features

- Rocky Mountain Turf’s rubber buffing is a durable unitary surface designed specifically for playgrounds. The surface serves as a rubber attenuation layer to minimize force of impact and is installed at different thicknesses to accommodate designated critical fall heights.
- The Rubber buffing surface is installed as a bottom layer under artificial turf in a playground surface system. This system provides an easily accessible and a durable surface allowing play for children and adults of all abilities.

CAD Drawing

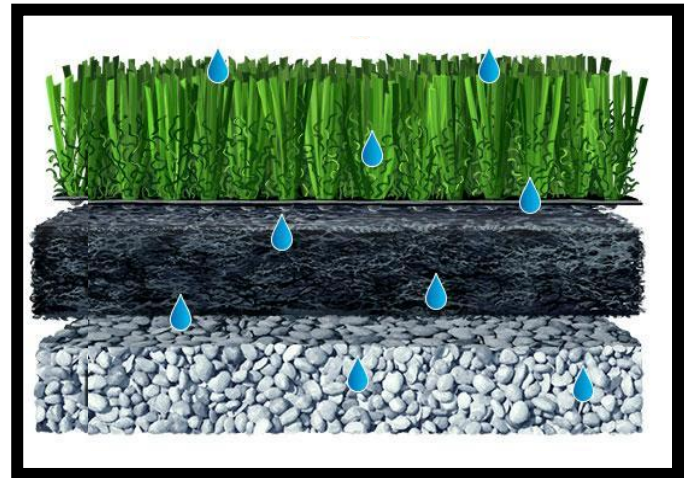

Specifications

- Attenuating layer consists of recycled shredded rubber buffings with a urethane bonding agent and is installed per your equipment’s requirements.
- Asphalt, concrete, or compacted stone base are suitable sub-bases

Fall Height Chart

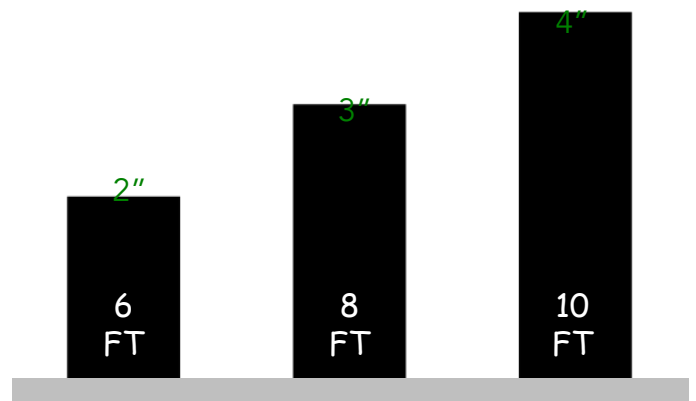

Additional Information

This product is part of Rocky Mountain Turf’s Product Series and was designed and engineered for playground artificial grass applications.



Potential Renderings for Playground Surfaces

Artificial Turf with No Fall Height

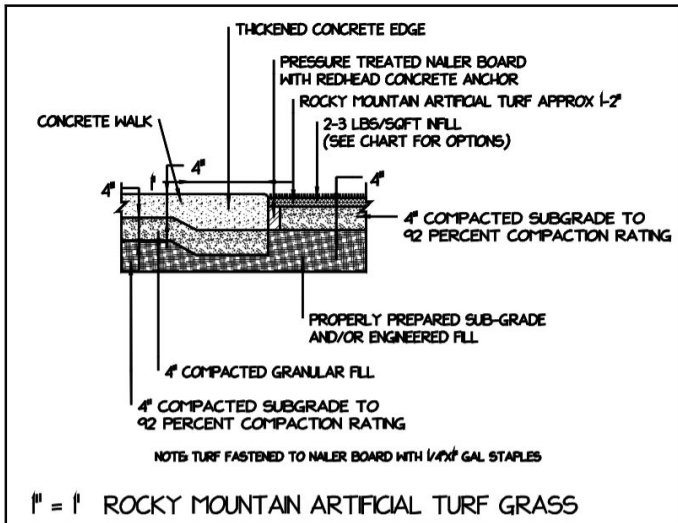

Artificial Turf with Foam Padding

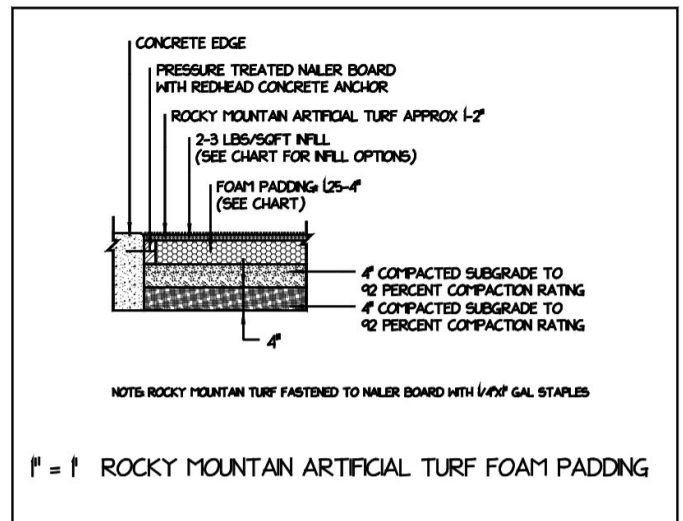

Artificial Turf with Rubber Buffings

